



1.800.465.6281
www.TCHWEB.com

Buffalo • Calgary • Dallas
Montreal • Toronto

**FAMILY - Q
WASHERS**

UPDATE 2016 - INCH



BOTECO®

ALL PURPOSE HANDGRIPS

Q260

DUROPLAST KNURLED WASHER



Material:

Duroplast.
Oils and greases resistant.
High temperatures resistant.

Surface:

Glossy.

Colour:

Black (RAL 9011).

Main Insert:

Zinc plated steel bush with right through threaded bore (tolerance 2B).

SPECIAL REQUEST:

- It is possible to supply the inserts in different materials, on request and for quantities.

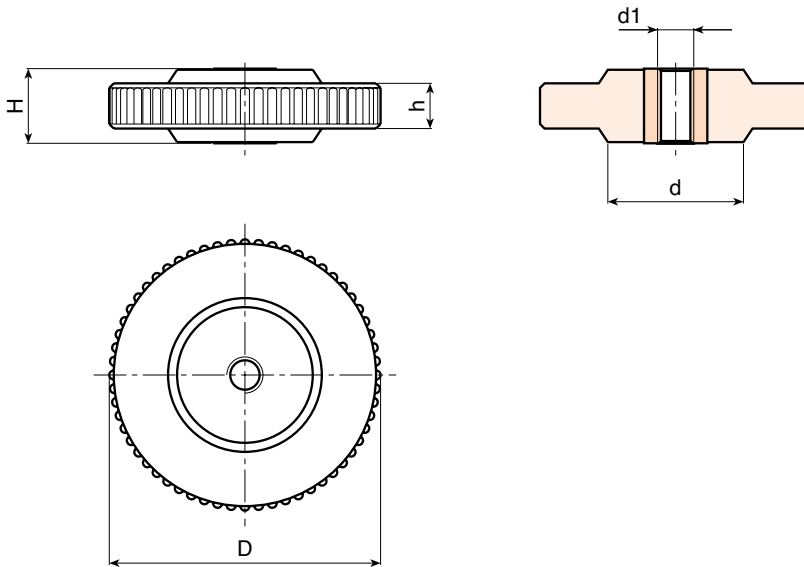

art.	D	H	d	h	d1 2B	oz
Q26045.BU1/401P	1,8504	0,3937	-	-	1/4-20	1,09
Q26045.BU5/1601P	1,8504	0,3937	-	-	5/16-18	1,13
Q26045.BU3/801P	1,8504	0,3937	-	-	3/8-16	1,20
Q26045.BU1/201P	1,8504	0,3937	-	-	1/2-13	1,24
Q26060.BU5/1601P	2,3622	0,6299	1,1811	0,4331	5/16-18	1,34
Q26060.BU3/801P	2,3622	0,6299	1,1811	0,4331	3/8-16	1,48
Q26060.BU1/201P	2,3622	0,6299	1,1811	0,4331	1/2-13	2,19



LOBED WASHER

Q261



Material:

Reinforced polyamide.
Oils and greases resistant.

Surface:

Satin.

Colour:

Black (RAL 9011).

Main Insert:

Zinc plated steel bush with right through threaded bore (tolerance 2B).

SPECIAL REQUEST:

- It is possible to supply the inserts in different materials, on request and for quantities.
- It is possible to supply colours as shown in the table at pag. Q-7, on request and for quantities.

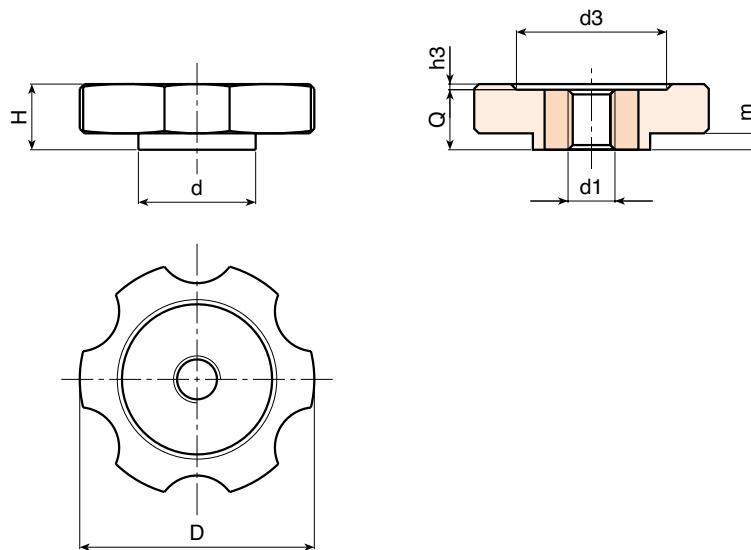

art.	D	H	d	m	h3	d3	d1 2B	Q	oz
Q26140.TU1/401P	1,5748	0,4724	0,9843	0,0787	0,0591	0,8661	1/4-20	0,4331	0,73
Q26140.TU5/1601P	1,5748	0,4724	0,9843	0,0787	0,0591	0,8661	5/16-18	0,4331	0,74
Q26140.TU3/801P	1,5748	0,4724	0,9843	0,0787	0,0591	0,8661	3/8-16	0,4331	0,78
Q26140.TU1/201P	1,5748	0,4724	0,9843	0,0787	0,0591	0,8661	1/2-13	0,4331	0,85
Q26150.TU5/1601P	1,9685	0,5512	0,9843	0,1378	0,0591	1,2598	5/16-18	0,5118	1,09
Q26150.TTU3/801P	1,9685	0,5512	0,9843	0,1378	0,0591	1,2598	3/8-16	0,5118	1,13
Q26150.TU1/201P	1,9685	0,5512	0,9843	0,1378	0,0591	1,2598	1/2-13	0,5118	1,24

Presumable presence in the stock in %

(🏭) 90% (☺) 40% (☹) 5% (⊖)

© BOTECA® - Reproduction prohibited - www.boteco.it



BOTECA

Q - WASHERS



Q262

PLASTIC KNURLED WASHER



PA6
+GF

UL94
HB



Material:

Reinforced polyamide.
Oils and greases resistant.

Surface:

Satin.

Colour:

Black (RAL 9011).

Hole:

Female threaded right through hole obtained by moulding the plastic. (tolerance in not applicable).

SPECIAL REQUEST:

- It is possible to supply colours as shown in the table at pag. Q-7, on request and for quantities.

RICHIESTE SPECIALI:

- It's possible to supply the d1 bore by customer design, on request and for quantities.

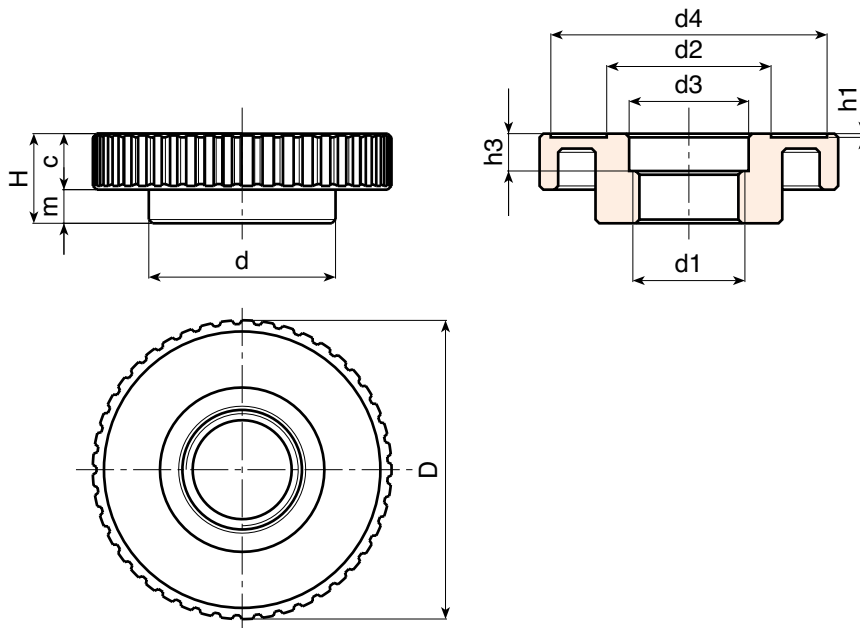

art.	D	H	d	c	m	h1	h3	d2	d3	d4	d1	oz
Q26280.TB3001P	3,1890	0,9449	1,9685	0,5709	0,3740	0,0394	0,3937	1,7126	1,2598	2,9134	1 1/4-7	2,29



PLASTIC KNURLED WASHER

Q263



Material:

Reinforced polyamide.
Oils and greases resistant.

Surface:

Satin.

Colour:

Black (RAL 9011).

Hole:

Female threaded right through hole obtained by moulding the plastic. (tolerance in not applicable).

SPECIAL REQUEST:

- It's possible to supply the d1 bore by customer design, on request and for quantities.

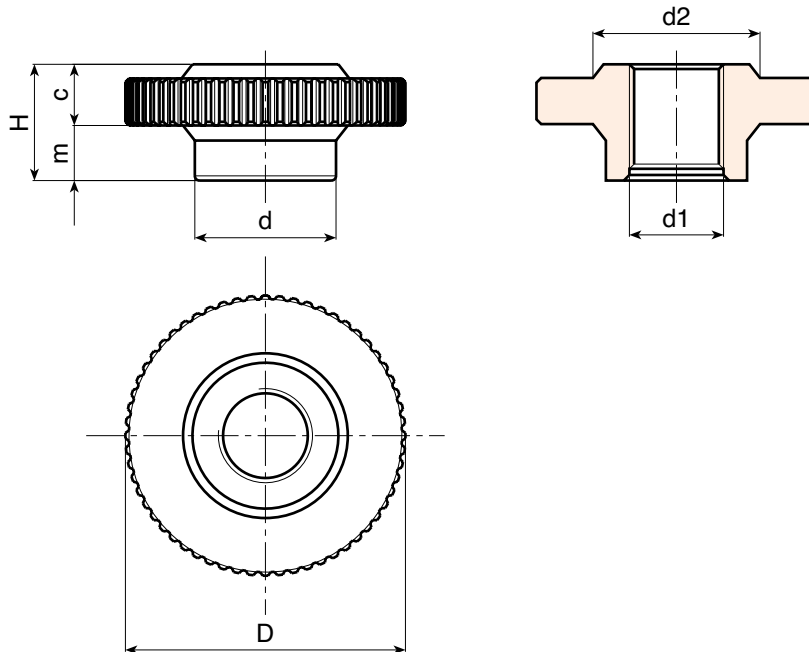

art.	D	H	d	c	m	d2	d1	oz
Q26360.TU3/401P	2,3622	0,9843	1,1811	0,4724	0,5118	1,3780	3/4-10	1,34

Presumable presence in the stock in %

(🏭) 90% (☺) 40% (☹) 5% (⊖)

© BOTECO ® - Reproduction prohibited - www.boteco.it



BOTECO

Q - WASHERS



Q264

6 LOBE WASHER



PA6
+GF

UL94
HB



Material:

Reinforced polyamide.
Oils and greases resistant.

Surface:

Satin.

Colour:

Black (RAL 9011).

Main Insert:

Brass bush with right through threaded bore (tolerance 2B).

SPECIAL REQUEST:

- It is possible to supply the inserts in different materials, on request and for quantities.
- It is possible to supply colours as shown in the table at pag. Q-7, on request and for quantities.

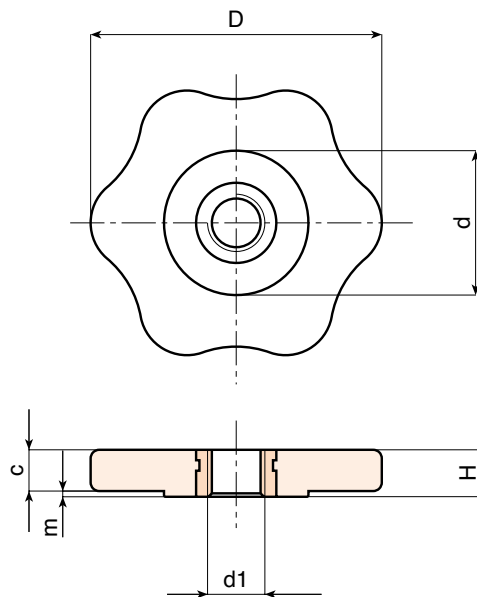











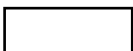



art.	D	H	d	c	m	d1 2B	oz
Q26450.TU1/401P	1,9685	0,3150	0,9843	0,2756	0,0394	1/4-20	0,64
Q26450.TU5/1601P	1,9685	0,3150	0,9843	0,2756	0,0394	5/16-18	0,64
Q26450.TU3/801P	1,9685	0,3150	0,9843	0,2756	0,0394	3/8-16	0,65















COLOUR CHART

RAL COLOURS CODING

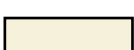
Colour		RAL	Cod.
Black		9011	01
Orange		2004	02
Orange		2011	03
White		9010	04
Blue		5002	05
Blue		5005	06
Blue		5015	07
Blue		5018	19
Blue		5019	21
Blue		5010	22
Yellow		1007	09
Yellow		1021	10
Grey		7024	12
Grey		7035	13
Red		3000	16
Green		6024	17

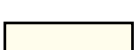
OTHER COLOURS

Colour		Ref.	Cod.
White		-	52
Blue		-	53
Blue		pant. 645 U	54
Blue		pant. 300	55
Grey		-	57
Grey		-	59
Grey		NCS 7500	60
Red		-	64
Red		-	65
Natural		-	66
Green		-	70
Brown		-	71
Cream		-	72
Violet		-	73





VENETO



BOTECA Srl
www.boteco.it

36010 ZANE' (VI) - ITALY

Via L. Pettinà 16 (side street of Via Cuso)

Switchboard Tel.:+39-0445-316411 - Fax:+39-0445-316400

Sales Fax:+39-0445-316401 mail: commerciale@boteco.it

Administration Fax:+39-0445-316402 mail: amministrazione@boteco.it

Technical Fax:+39-0445-316404 mail: tecnico@boteco.it

Certified Mail Box: boteco@pec.botecopec.it



AUTHORISED RESELLER



ver. QUS.01-0916